



## Art.Nr.: 74000411 - Verteilergetriebe

- glasfaserverstärktes Kunststoffgehäuse
- gefräste Zahnräder aus Stahl
- alle Wellen aus rostfreiem Stahl
- 6-fach kugelgelagert
- Übersetzung 2,65 : 1



www.SCALEDRIVE.de



ScaleART OHG - Schillerstraße 3-7 - D67165 Waldsee  
Tel.: +49 (0) 6236-416651 - Mail: info@scaleart.de

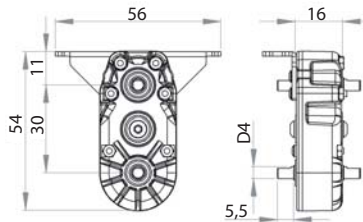

01	Gehäuse Verteiler	1	24000427
02	Lagerschild Verteiler	1	24000434
03	Halter Verteiler	1	24000448
04	Zahnrad Z26	2	24000438
05	Zahnrad Z16	2	24000402
06	Mutter M6x0,75	2	24000435
07	Ausgangswelle Verteiler	2	24000414
08	Zwischenwelle Verteiler	1	24000439
09	Flanschlager 5x9x3	6	32900036
10	Schraube M2x4	3	32000010
11	Schraube M2x16	3	32000017
12	Schraube M2x18	3	32000018
13	Senkkopfschraube M2x16	3	32000077
14	Inbusschraube M3x4	3	32000604
15	Mutter M2	8	32000002
16	Stift D2x6	3	32000391
17	Stift D2x8	3	32000382
18	Fett Tube 10g	1	60000507

Zur Montage wird das folgende Werkzeug benötigt:



- Kreuzschlitzschraubendreher Art.Nr.: 96000007
- Steckschlüssel 4,0mm Art.Nr.: 96000016
- Innensechskantschlüssel 2mm Art.Nr.: 96000010
- Gabelschlüssel 7mm Art.Nr.: 96000027
- Spitzzange Art.Nr.: 96000051
- Skalpell Art.Nr.: 96000036
- Schraubensicherung mittelfest Art.Nr.: 60000504
- kleine Feile

### Hinweis zur Montage!

Fertigungsbedingt kann an Bohrungen oder Flächen auf Wellen ein Grat entstehen. Diese müssen mit einer Feile oder etwas Schmirgelpapier entfernt werden, so dass sich die Lager leicht auf die Welle schieben lassen.

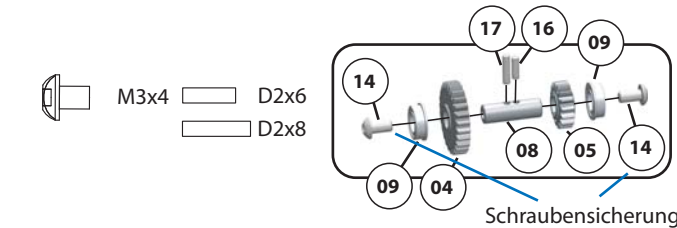
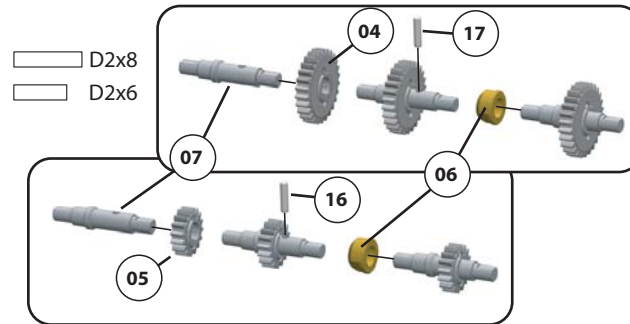
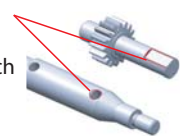

Achten Sie beim Einpressen der Lager darauf, dass der Bund am Lager exakt am Lagerschild anliegt und die Kugellager immer von der richtigen Seite eingesetzt sind.

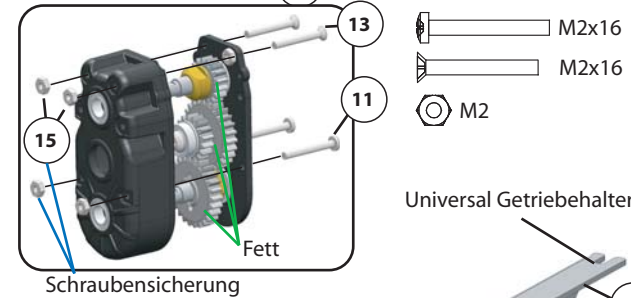
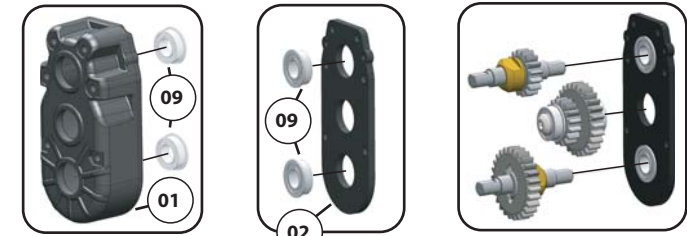
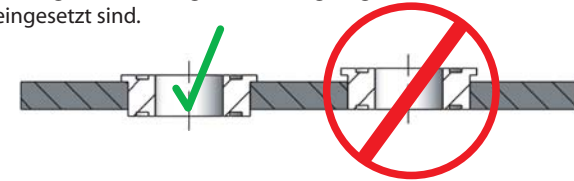

- M2x16
- M2x16
- M2

Universal Getriebehälter



### Kardanwelle:

Rahmentransverse aus ScaleDRIVE Fahrgestell

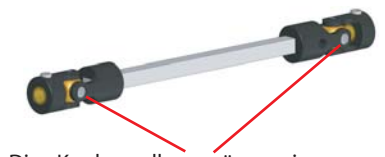

Die Kardanwellen müssen immer so eingebaut werden, dass die Gelenkaußen in einer Flucht stehen.



Item nr.: 74000411 - transfer case

- fibre-glass reinforced plastic case
- milled gears made of steel
- all shafts made of stainless steel
- 6-times ball bearings
- transmission 2,65 : 1



www.SCALEDRIVE.de



ScaleART OHG - Schillerstraße 3-7 - D67165 Waldsee  
Tel.: +49 (0) 6236-416651 - Mail: info@scaleart.de

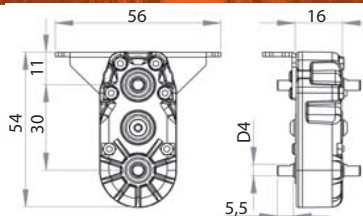

01	distributor case	1	24000427
02	distributor bearing plate	1	24000434
03	support for distributor	1	24000448
04	gear wheel Z26	2	24000438
05	gear wheel Z16	2	24000402
06	nut M6x0,75	2	24000435
07	output shaft of distributor	2	24000414
08	intermediate shaft of dist.	1	24000439
09	ballbearing 5x9x3	6	32900036
10	screw M2x4	3	32000010
11	screw M2x16	3	32000017
12	screw M2x18	3	32000018
13	countersunk screw M2x16	3	32000077
14	allen screw M3x4	3	32000604
15	nut M2	8	32000002
16	pin d2x6	3	32000391
17	pin d2x8	3	32000382
18	grease 10g	1	60000507

Following tools are required for assembly:



Phillips screwdriver  
socket wrench 4,0mm  
allen key 2mm  
open-end wrench 7mm  
nose plier  
scalpel  
thread locking fluid medium str.  
small file

item nr.: 96000007  
item nr.: 96000016  
item nr.: 96000010  
item nr.: 96000027  
item nr.: 96000051  
item nr.: 96000036  
item nr.: 60000504

### Hint for assembly!

Due to manufacturing tolerances there can be burrs on holes and surfaces. These must be removed with a file or sandpaper to guarantee that the parts are fitting together.

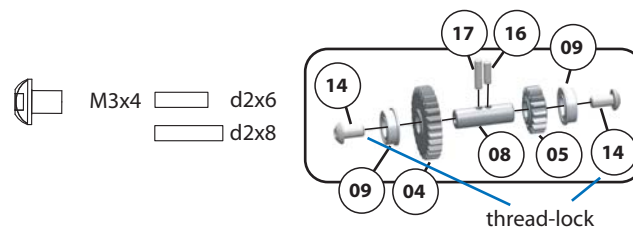
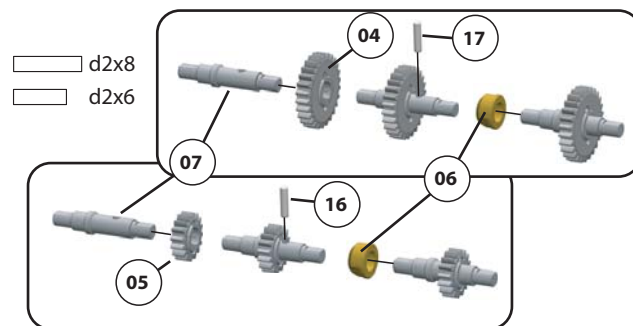
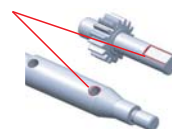

When fitting the bearing make sure that the flange rests exactly on the bearing plate and the ball bearing is always inserted from the right side.

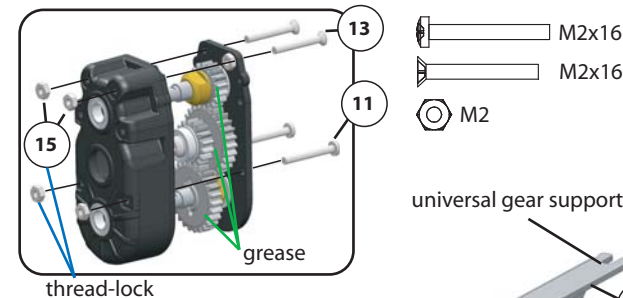
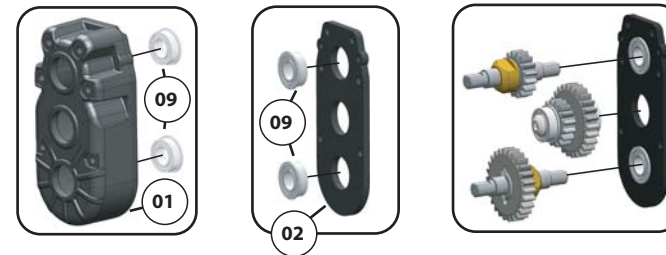
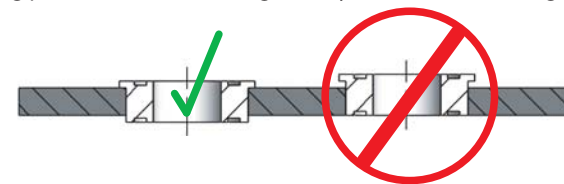

M2x16  
M2x16  
M2

universal gear support

M2x18  
M2  
M2x4

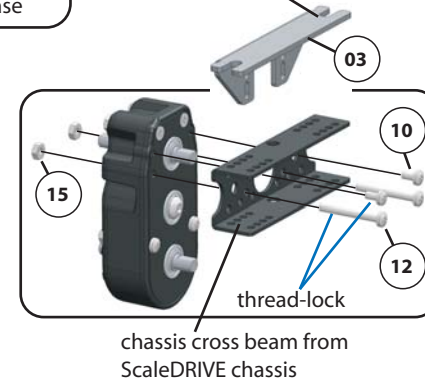

### Drive shaft:



Make sure that the eyes of the joint are facing in the same direction when mounted.